

Cómo llegar / Getting here



Edificio Nexus / Nexus building



Edificio CPI / CPI building

Lunes 18:

Cost ic0603 Assist : Aula 2.8 edificio Nexus

Cost 2100: Edificio CPI

- Planta 3^a, nivel de terraza
- Planta 4^a, salas Descubre y Debate

Martes 19:

Cost ic0603 Assist : Aula 2.8 edificio Nexus

Cost 2100: Edificio CPI

- Planta 3^a, nivel de terraza
- Planta 4^a, salas Descubre y Debate

Miércoles 20:

Cost ic0603 Assist y Cost 2100: Salón de actos edificio Nexus

Monday 18th:

Cost ic0603 Assist : Room 2.8 Nexus building

Cost 2100: CPI building

- Third floor, terrace level
- Fourth floor, *Descubre* and *Debate* rooms

Tuesday 19th:

Cost ic0603 Assist : Room 2.8 Nexus building

Cost 2100: CPI building

- Third floor, terrace level
- Fourth floor, *Descubre* and *Debate* rooms

Wednesday 20th:

Cost ic0603 Assist and Cost 2100: Conference room Nexus building

Edificio Nexus / Nexus building

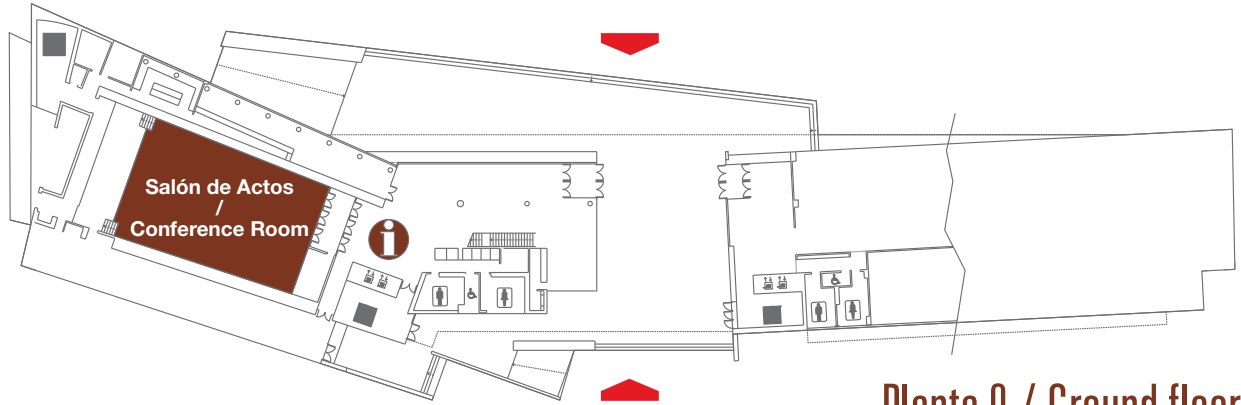

Planta 0 / Ground floor

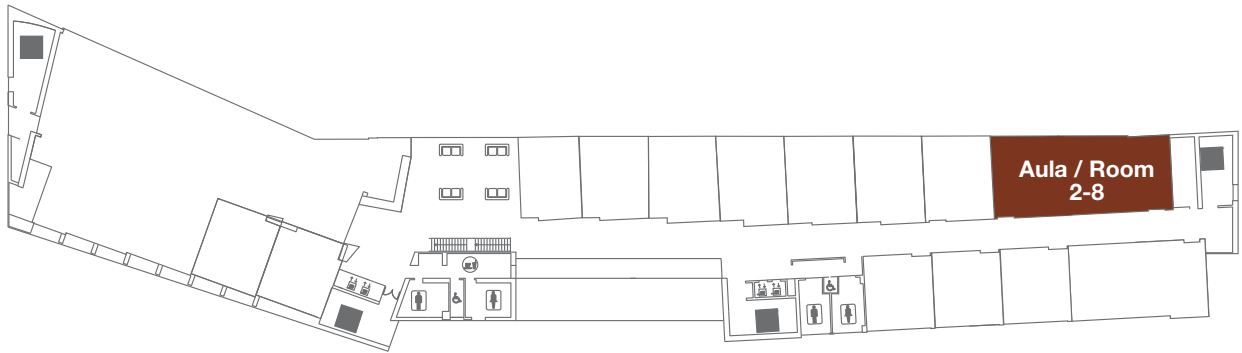

Planta 2 / Second floor

Edificio CPI / CPI building



Tercer piso, nivel de terraza
Third floor, terrace level

Hoteles y Universidad / Hotels and University



Cómo llegar desde su alojamiento a la UPV

Transportation from hotels to UPV

Hospes Palau De La Mar:

Metro / Underground (www.metrovalencia.es)

- línea /line 3: dirección Palmaret o Rafelbunyol en la estación Alameda / Palmaret or Rafelbunyol direction, Alameda station
- Línea /line 4, 6: Transbordo en Benimaclet / Transfer in Benimaclet station
- Llegada a Serrería / Arrival in Serrería station



- Caminando: 45 min.
- By foot: 45 min.



NH Las Artes:

Autobús / Bus (www.emtvalencia.es)

- Línea1
- Line 1

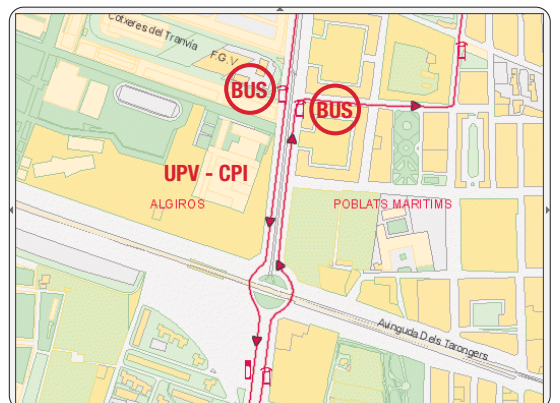
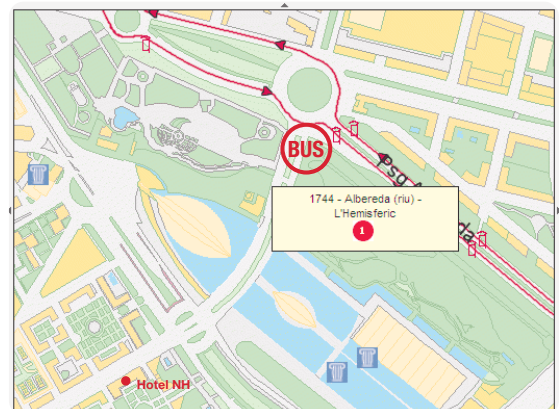
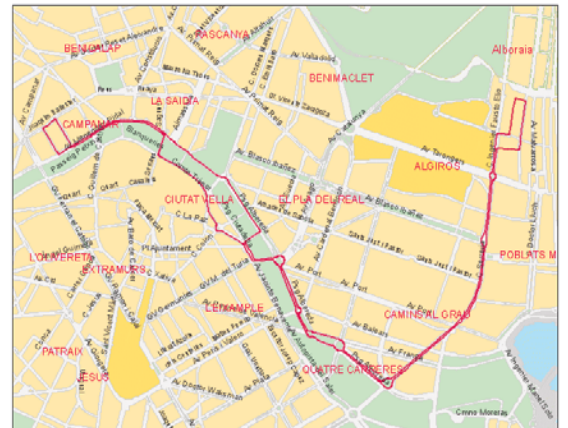

Restaurants / Restaurants

